

UNISTER DUO

Electronic draft adjuster

Cat. no. 201313



DRAFT ADJUSTER

The Unister Duo electronic draft adjuster is intended for controlling the boiler temperature through opening and closing the air intake flap of the boiler's furnace. In addition, the device controls the switching of the circulation pump in heating systems and of the exhaust fan.

THE DRAFT ADJUSTER OFFERS THE FOLLOWING FUNCTIONS:

- maintaining the set boiler temperature through air supply control
- exhaust fan operation control
- function maintaining the firing process, i.e. blowing
- automatic control switch off after the boiler is shut down
- lowering the flap in case of supply power loss
- closing air supply when fuel is added to the boiler furnace
- central heating circulation pump control
- COMFORT SYSTEM function protecting the pump from scale build up
- boiler protection against freezing and overheating
- temperature sensor damage signalling
- motor block/malfunction signalling
- screen brightness control - increased during setting changes
- possibility of connecting a CONTROL remote control panel with an audio alarm



INTELIĞENTNE ROZWIĄZANIA

Sales office: 53-030 Wrocław, ul. Przyjaźni 141 | phone 71 / 333 73 88 | phone 71 / 333 74 36 | fax. 71 / 333 73 31
www.dksystem.pl | biuro@dksystem.pl | Register number: 000015633

TECHNICAL SPECIFICATIONS	UNISTER DUO
Measured temperature range	from - 9 °C to + 99 °C
Boiler temperature setting range	from + 40 °C to + 85 °C
Air intake flap raising hysteresis	from 0 °C to 9 °C
Central heating pump temperature setting range	from + 35 °C to + 70 °C
Central heating pump hysteresis (on - off difference)	2 °C
Blowing control (possibility of completely switching off the blowing function)	operation: 0 - 90 seconds break: 1 - 15 minutes
Nominal supply voltage	230 V, 50 Hz
Nominal load	275 W
Permissible central heating pump power	100 W / 230 V
Permissible fan power	200 W / 230 V
Relative humidity	< 95 %
Protection rating	IP 40
Insulation class	I
Controller dimensions	125 x 115 x 53 mm
Ambient temperature	from 0 °C to + 40 °C
Electrical protection	2.5 A
Automatic STOP - with no fuel in the boiler	yes

CONNECTION DIAGRAM FOR CONNECTING THE DRAFT ADJUSTER TO THE HEATING SYSTEM

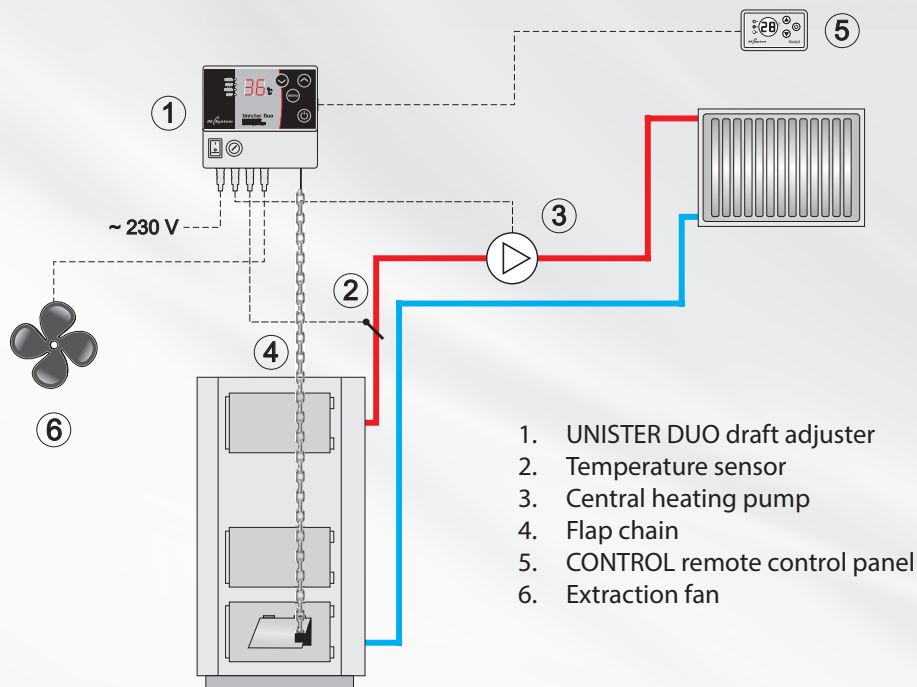

Example heating system diagram with a UNISTER DUO controller without cut off and protection devices. It does not replace a professional design at the installation site.